

# Plate Heat Exchanger

- for high-rise heating applications
- for heating separate fluid supply

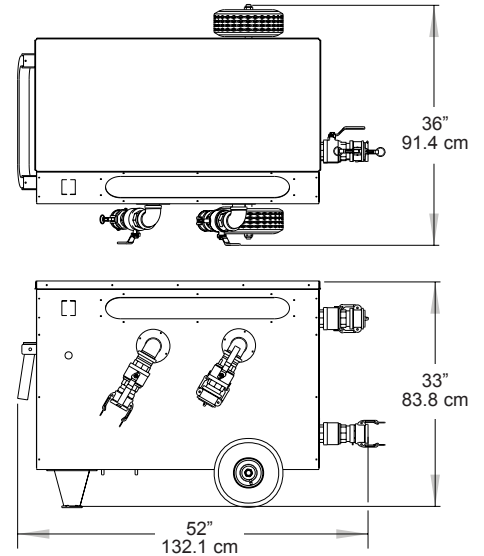

## Features:

- The plate heat exchanger, combined with a central heating module, is the perfect solution for delivering heat on a multi-storied project while still keeping the heat source at ground level.
- Can circulate heat transfer fluid up to 70 feet (21 M) above the central heating module's elevation utilizing our standard primary fluid lines.
- Provides a fluid distribution system totally separate from the central heating module. The central heating module provides a fluid "hot" loop. The plate heat exchanger transfers heat from the central heating module "hot" loop to the separate "plate heat exchanger" fluid distribution system.

## Specifications

Weight - wet.....	- 500 lbs., 227 KG
Electrical .....	- 230V, single phase, 60Hz, 30A
Pump .....	- RPM - 3500
.....	- 3 HP, 2.24 KW
.....	- Flow - 80 US GPM @ 35 P.S.I.,
.....	- 18.12 M <sup>3</sup> /HR @ 24.5 M W.C.
Controls & Monitoring .....	- Pressure gauge for heat exchange
.....	- circulation loop.
.....	- Supply and return temperature
.....	- gauges for boiler circulation loop.
.....	- Supply and return temperature gauge
.....	- for heat exchanger circulation loop.
.....	- Pump control switch (on - off).

## Fluid Circulation

### Central heating module circulation loop

- .....- Single supply and return
- .....- Kamlock quick couplers & ball valves - 2", 50 MM

### Plate heat exchanger circulation loop

- .....- Single supply and return, - 2" (50.8 MM) kamlock quick couplers & ball valves
- .....- Primary circulation line - 1 1/2" (40 MM) primary circulation lines can be used for applications using up to 400 ft. (122 M) of line. 2" (50 MM) primary circulation lines must be used for applications using over 400 ft. (122 M) of line.